

CERTIFIED LAND CORNER RECORDATION

DESCRIPTION OF CORNER EVIDENCE FOUND, AND ORIGINAL RECORD (if known)

LOCATION

Found 8" x 8" x 16" Granite boulder with "1/4" on north face.

1/4 S.21
1/4 S.28

T.14N., R.67W.
6th P.M.

DESCRIPTION OF MONUMENT AND ACCESSORIES ESTABLISHED
TO PERPETUATE THE ORIGINAL LOCATION OF THIS CORNER:

At the corner: Set 1 1/2" dia. x 30" long iron pipe with brass cap.

Accessories: Left stone as memorial.

SKETCH, WITH COURSE AND DISTANCE TO ADJACENT CORNER IF DETERMINED IN THIS SURVEY.
(May Sketch or Paste Reproduction on Reverse Side.)

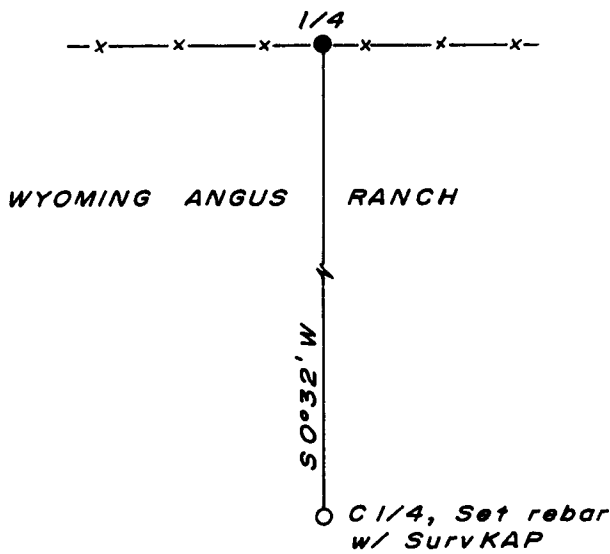

Brass cap set 4" above ground.

Brass cap stamped:

T.14N. R.67W.

1/4 S.21
1/4 S.28

LS 519 1973

I, R.L. Hudson certify that I have carefully performed ~~or reviewed~~ the work done on the diagrammed corner as reported on this recordation form and approve the same.

R.L. Hudson
Signature of Surveyor

Wyoming L.S. No. 519
Registration No.

STATE OF WYOMING,

Office of Clerk and Recorder,

County of Sarasie

This "corner record" was filed for record on the 19 day of November, 1973, was noted on the cross-index plat and is assigned page No. _____, in book No. _____.

John B. Huisman
County Official

Cross Index No. <u>R 11</u>	T. <u>14</u>	R. <u>67</u>	<u>6</u> Mer.
_____	T. _____	R. _____	Mer.
_____	T. _____	R. _____	Mer.
_____	T. _____	R. _____	Mer.
_____	T. _____	R. _____	Mer.
_____	T. _____	R. _____	Mer.
_____	T. _____	R. _____	Mer.

307012

Photographed 1
Indexed B
Posted 1
Assessor 1

... was instrument was filed for record
at 10:15 o'clock A M. on the
19 day of November
A. D. 1973 and duly recorded in
Book on page

John A. Stillman

County Clerk & Ex-Officio Registrar of Deeds
By JB Dr.

R. L. Hurdless L. S. Regs No 519